

| MLS72 TB

## LIFT&SLIDE MLS72 TB

The Lift&Slide system MLS72 TB is a system for sliding openings of extraordinary weights and dimensions.

The system consists of solid steel tubular profiles, made of 2 mm thick sheet and shaped to form gasket grooves and a reinforced housing for the hardware. A slender frame (only 18 mm) with maximum resistance and the high thermal-acoustic performance of the thermal break technology in PA 6.6 polyamide. The profile depth of 72 mm allows the housing of large insulating glass panes, for door weighing up to 400 kg each leaf. MLS72 TB is available in galvanized steel which can be finished in any colour, Cor-Ten steel and stainless steel AISI 316L.



EN 12207

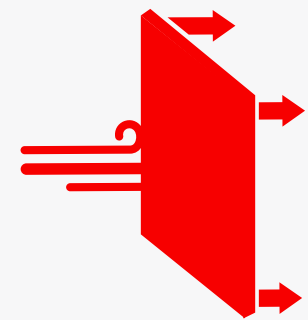

**Air permeability**  
3 Class - 600 Pa

EN 12208



**Water Tightness**  
7A Class - 300 Pa

EN 12210

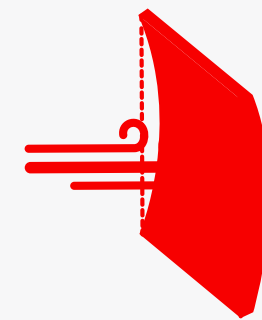

**Resistance to wind load**  
A3 Class - 1200 Pa

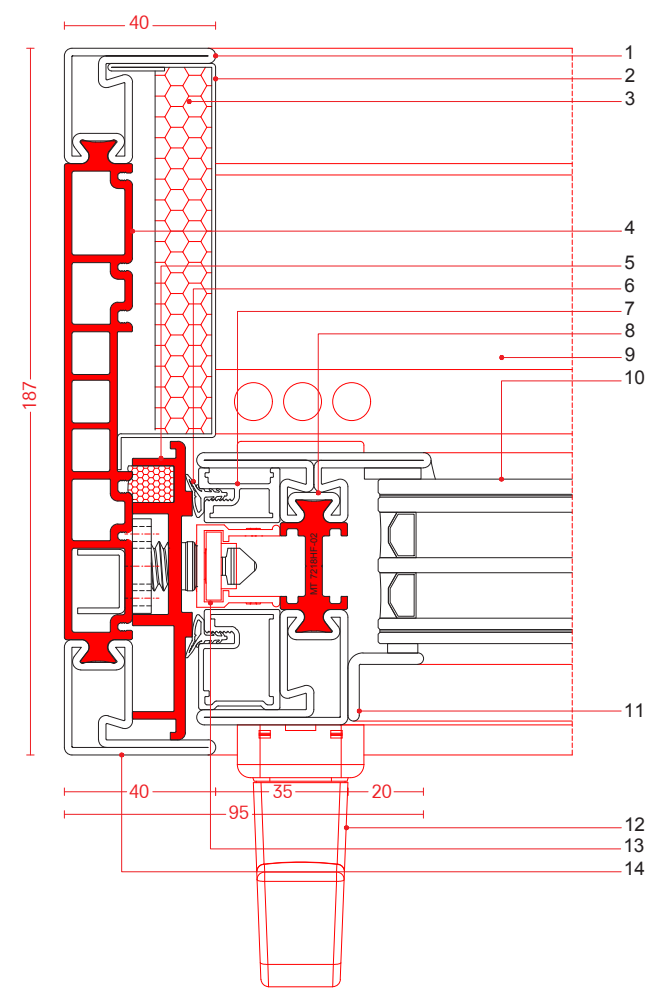

drawing scale 1:2

## FEATURES

- |  |  |  |
|--|--|--|
| 1. continuously laser welded profile, thickness 2 mm | 6. rebate gaskets  | glazing, including security glass up to 46 mm thick      |
| 2. aesthetic cover cap with insulating material      | 7. gasket groove   | 11. tubular snap on or "L" shaped, angular glazing beads |
| 3. insulator   | 8. thermal break profiles, available in galvanized steel, Cor_ten steel and AISI 316L 2B stainless steel | 12. choice of handles with different design              |
| 4. glassfibre reinforced PA 6.6 polyamide            | 9. thermally insulated stainless steel threshold   | 13. up to 400 kg   |
| 5. insulated front strike                            | 10. compatible with insulating   | 14. perimeter wall recessed frame                        |





PRIVATE HOUSE  
TREVISO, ITALY

OTTOSTUMM | **mogs**



Gr5





OTTOSTUMM | mogs



PRIVATE HOUSE  
USA

OTTOSTUMM | **mogs**



PRIVATE HOUSE  
ROME

OTTOSTUMM | **mogs**





PRIVATE HOUSE  
ROME

OTTOSTUMM | **mogs**



PRIVATE HOUSE  
USA

OTTOSTUMM | **mogs**

# DISTINCTIVE METALS

## Cold formed steel

Cold-rolled steel profiles - whether bright or galvanized - have a uniform texture, which lends itself well to multiple finishes. Light brushing or blackening can be used as an alternative to traditional painting, and allow a high level of customization of the frame. In interior design, the surfaces can be left natural or simply galvanized, to create industrial-style openings. The corners of cold rolled steel doors and windows are always welded. Depending on the desired visual quality, the welds can be ground flat, left natural or even emphasized by brushing or blackened with special patinas. The Series FerroFinestra W50 TB and FerroFinestra W75 TB are cold rolled in high-precision production lines to ensure perfect windows and doors.

## Cor-Ten steel

Cor-Ten is a material of great scenic effect and extraordinary elegance. In recent years, it has become a very popular material for windows and doors, both for restoration and for new buildings. Cor-Ten is a natural, living material that takes on different and unique shades over time and through exposure to the elements. The natural oxidation process can also be controlled chemically, with procedures that reduce natural "bleeding". In order to contain these phenomena, however, it is advisable to plan periodic treatments with applications of suitable waxes or oils. The corners of the frames are suitably welded, and the welding mark can be left natural or ground flat.

## Stainless steel

The technical properties and remarkable resistance over time make stainless steel a very popular material used in construction and architecture since 1920. Its exceptional characteristics allow its use even in areas subject to strong environmental aggression, for roofs, curtain walls, doors and windows of very long duration, in almost total absence of maintenance. Appreciated above all for its metallic sheen, stainless steel allows extreme design freedom in terms of surface finishes, such as "black stainless steel", which can be obtained by applying special patinas on the brushed or sandblasted surface. Thanks to its natural and evocative texture, black stainless steel gives windows and doors an exclusive character. The corners of windows and doors made from cold rolled stainless steel profiles are mainly welded and welds are ground flat and polished. The steel chosen by Ottostumm | Mogs in the family products FerroFinestra W75 TB and Mogs 65 TB is considered as the best stainless steel alloy, AISI 316L stainless steel, containing the largest amount of molybdenum. AISI 316L is normally called "marine steel" because it is able to resist corrosion even in a highly salty environment.

OTTOSTUMM | **mogs**

OTTOSTUMM SA

Via Baragge, 2  
6855 Stabio - Switzerland  
T +41 (0)91 6417700 | [info@ottostumm.com](mailto:info@ottostumm.com)

[ottostumm-mogs.com](http://ottostumm-mogs.com)

OFFICIAL PARTNER OF OTTOSTUMM | **mogs**

# METALFORM

MASTERS OF METAL

**UNITED KINGDOM**

**METALFORM**

**NORWAYMETAL LTD**

53 Chelsea Manor Street

London, SW3 5RZ

**SALES@METALFORM.UK**

**+44 20 81298814**

**GERMANY**

**METALFORM GMBH**

Carl-Zeiss-Ring 15A

85737 Ismaning

**SALES@METALFORMGROUP.DE**

**+49 17663630406**

**NORWAY**

**METALFORM AS**

Brochmannsveien 2

1950 Rømskog

**SALG@METALFORM.NO**

**+47 401 62 446**

**METALFORMGROUP**

**SALES@METALFORMGROUP.COM**