

METALFORM

METALFORM

In partnership with

rp
technik
profile systems



Minimum elevation widths:
large-scale, slimline &
extremely resilient

RP-hermetic 40, RP-Design 50,
RP-hermetic 55N,
RP-hermetic 75 / 75 FB

Systems for windows, doors and partition walls



RP-hermetic 40

Profile overview

RP-hermetic 40

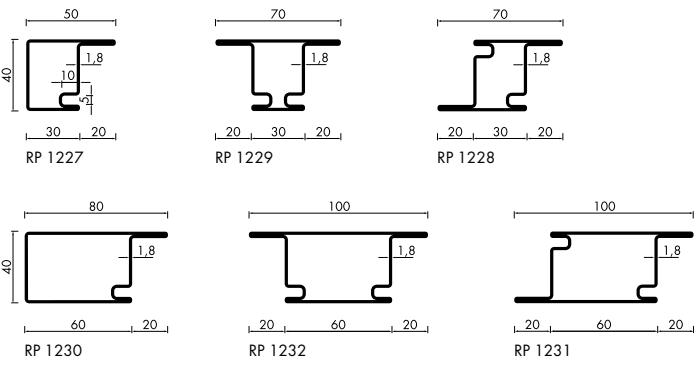

Steel glazing beads

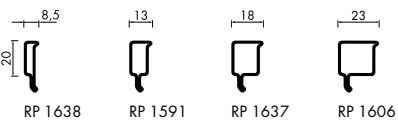

Aluminium glazing beads

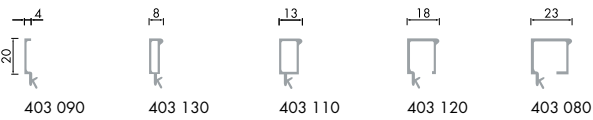

RP-hermetic 40

Door

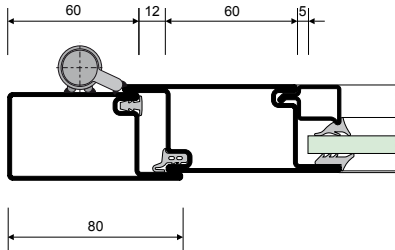

Partition wall

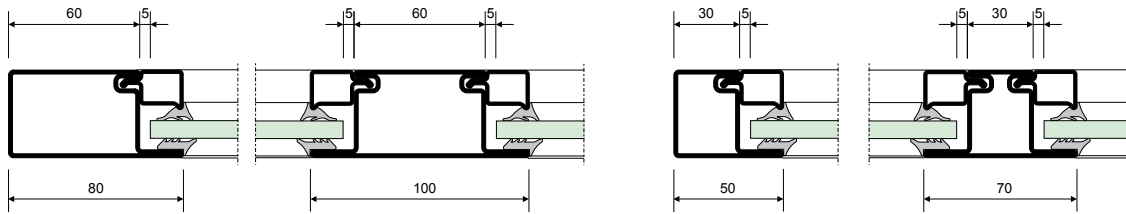

FUNCTIONAL AND DESIGN-ORIENTED

The advantages of steel can be fully realised in the construction industry, as it is the only material which affords minimum elevation widths with maximum span widths. Steel also stands out by virtue of its environment-friendly and sustainability. The RP Technik development team has translated stability and safety into a range of slimline and highly functional non-thermally insulated systems, which are also safety-certified. RP Technik's service-oriented system specialists would be happy to discuss individual custom designs with you. In terms of processing, RP Technik's non-thermally insulated steel profile systems are impressively economical. In addition to being simple to use and process, with a wall thickness of 1.5-1.8 mm, the steel profiles and frames ensure maximum stability.

- 1 Fire service training centre, Dortmund, Germany
- 2-3 Le Klay fitness studio, Paris, France



RP-Design 50

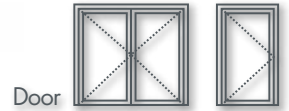
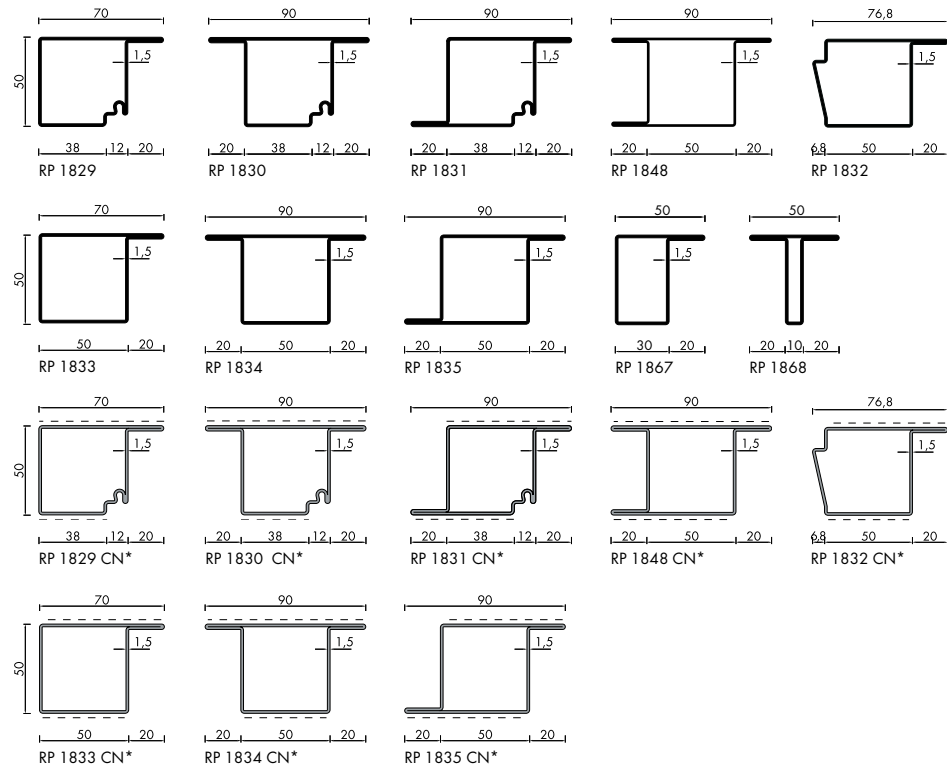

Steel glazing beads

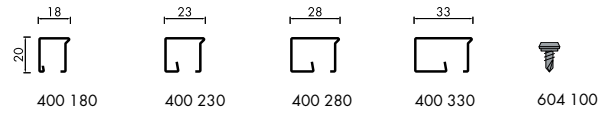

Stainless steel glazing beads

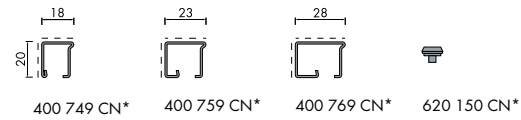

Aluminium glazing beads



* = Stainless steel 304 (1.4301)
 = Surface/visible surface ground, grain 220/240



RP-Design 50

Steel door

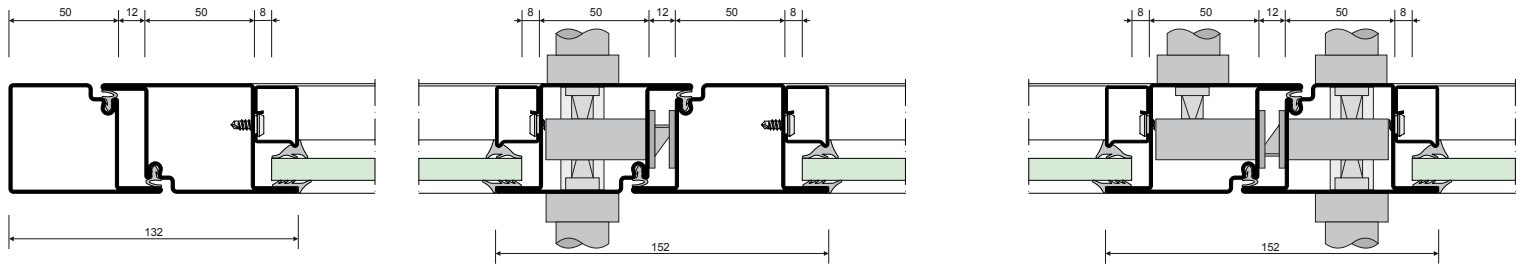

Steel partition wall

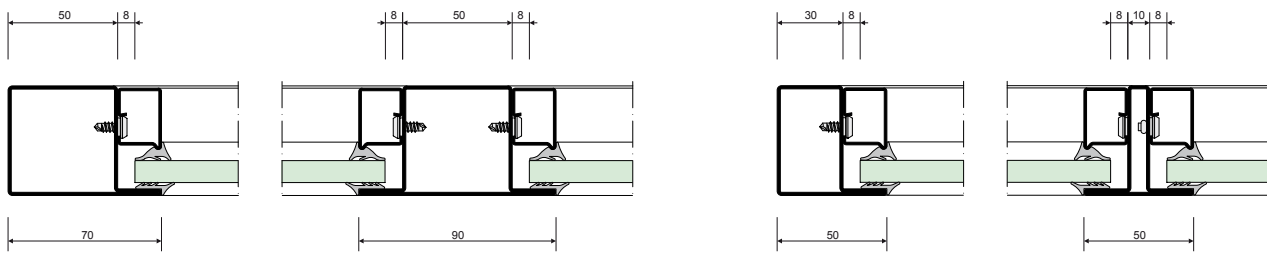

Stainless steel door

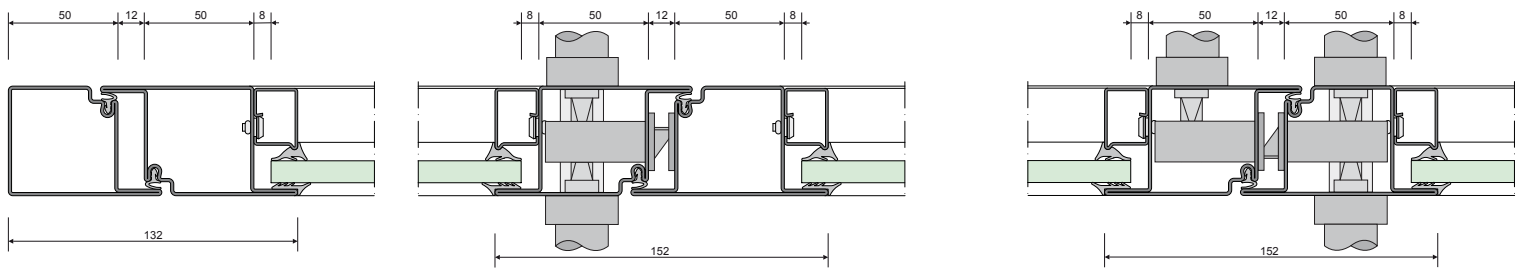

Stainless steel partition wall

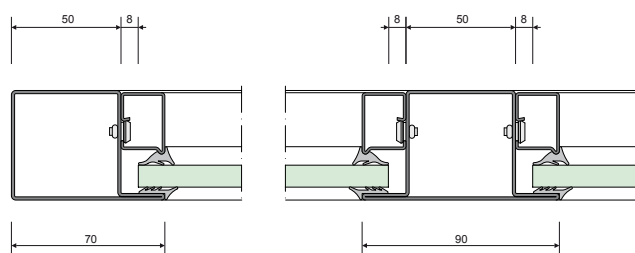

- 1 House, south of France
- 2 Office building, Paris, France
- 3 Mehnert family estate, Germany
- 4 Train station, Saint-Malo, France



Window

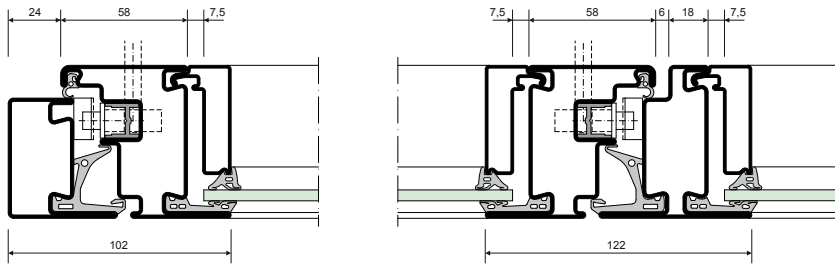

Partition wall

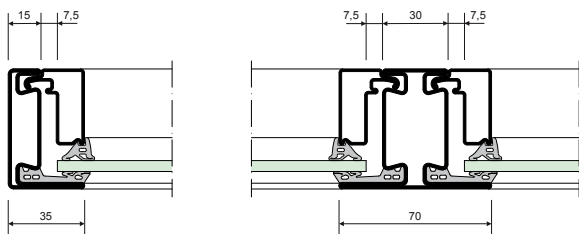

Door

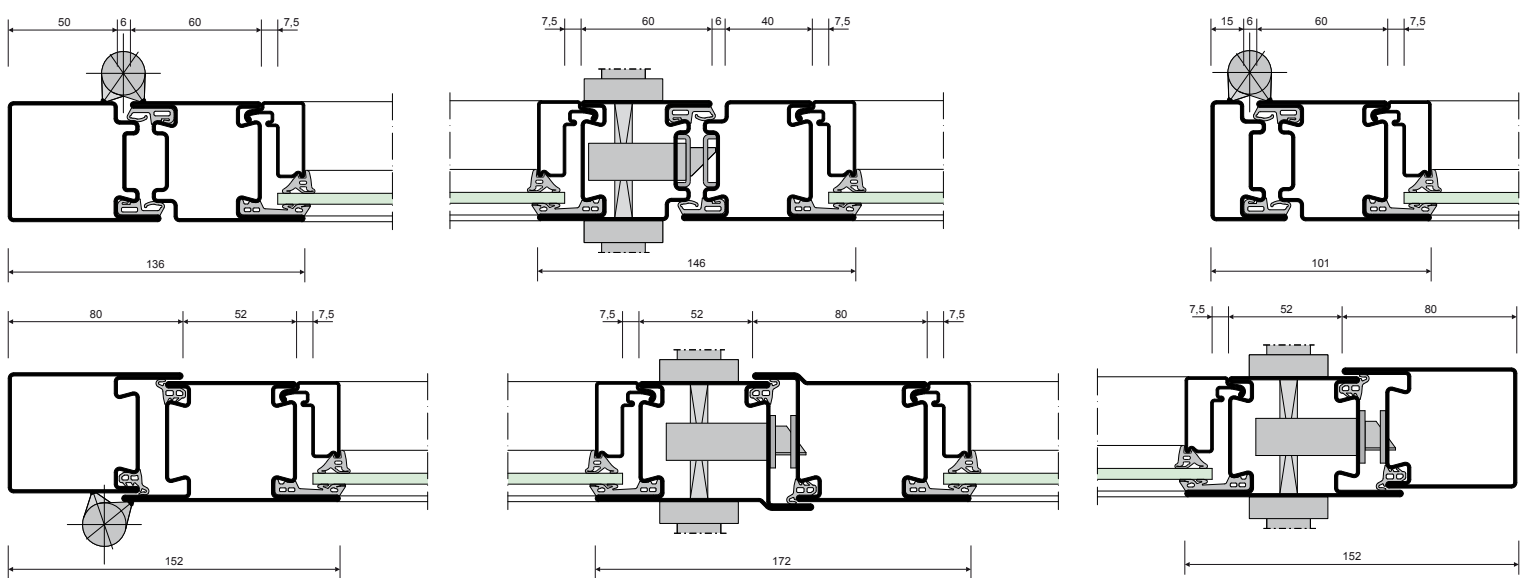

Finger-trapping protection door

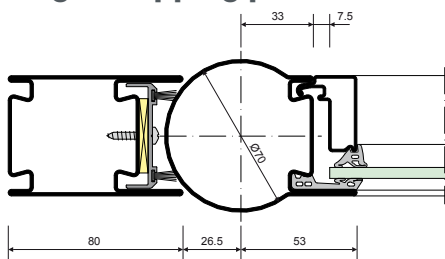

- 1 Trade fair exhibit, BATIMAT 2005, Paris, France
- 2 Apartment building, Paris, France
- 3 Town hall, Ollainville, France



RP-hermetic 75 / 75 FB

Profile overview

RP-hermetic 75

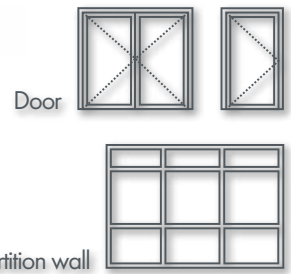
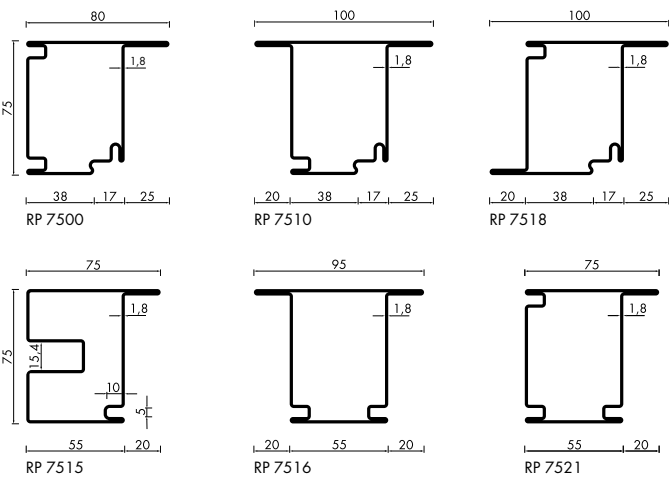

RP-hermetic 75 FB

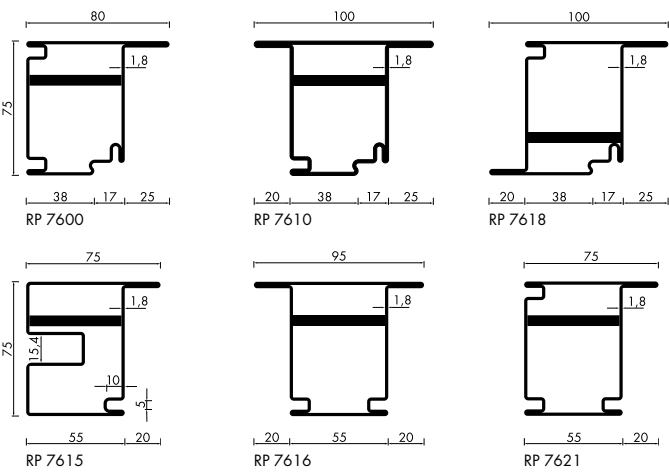

Reinforcement profiles for FB6 available on request

Steel glazing beads

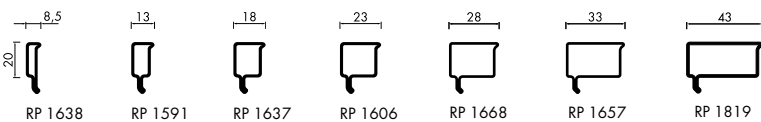

Aluminium glazing beads

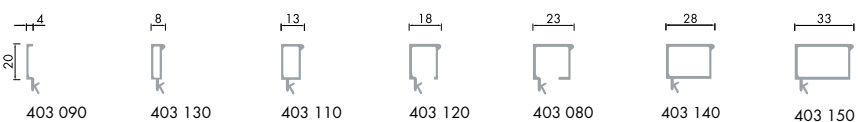

RP-hermetic 75

Door

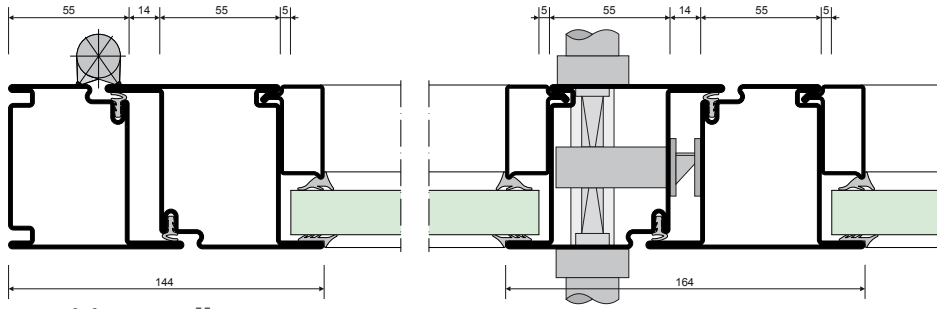

METALFORM

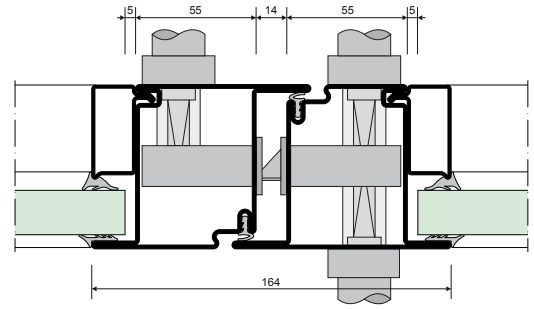

Partition wall

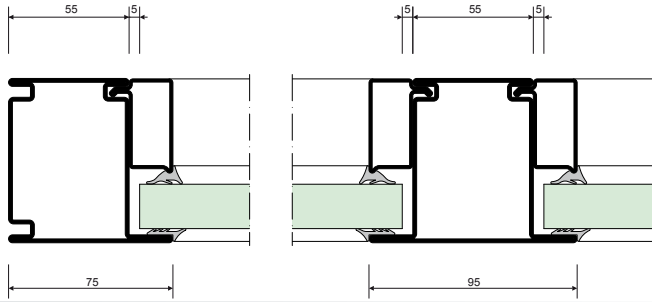

RP-hermetic 75 FB4

Door

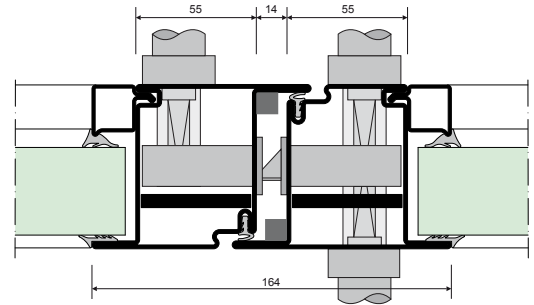
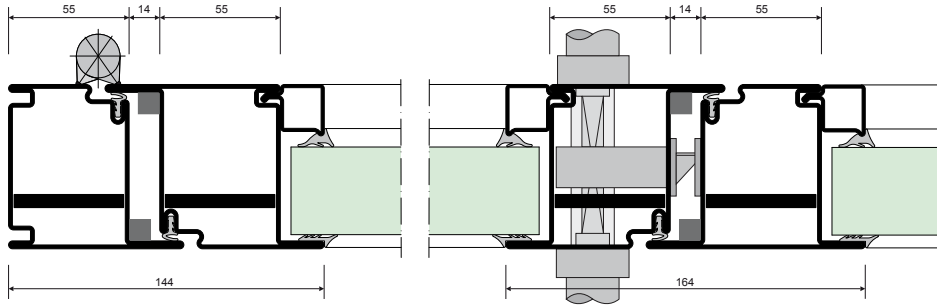

Partition wall

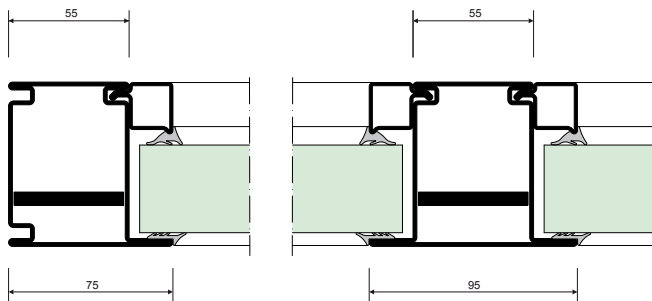

RP-hermetic 75 FB6

Doors

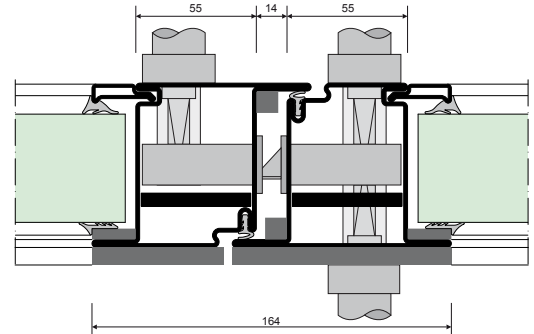
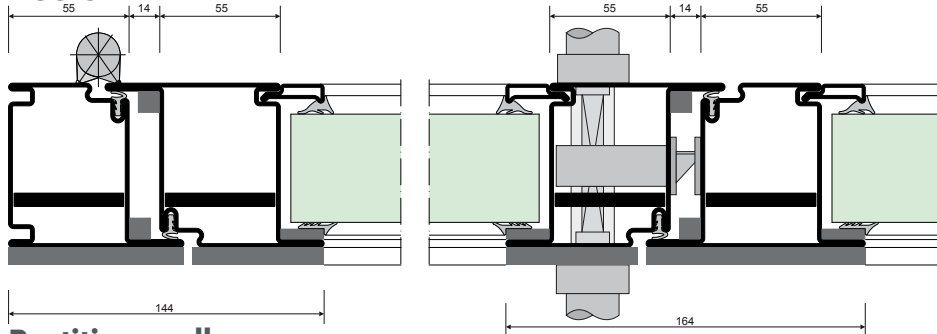

Partition walls

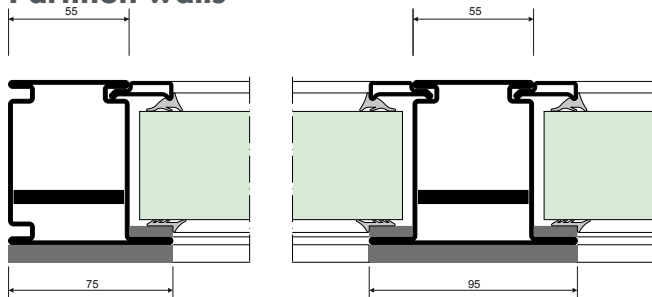

A LONG-STANDING AND SUCCESSFUL PARTNERSHIP

Close partnership with customers, translated into practical, day-to-day cooperation is a solid foundation for success. RP Technik is your unwavering partner for the development of steel profiles. From architects to planners, our customers benefit from a plethora of skills offered by a group of specialists working for a company which is both an expert in its field and active on the world stage. Insider knowledge of the industry and the full panoply of experience garnered from years of developing steel profiles mean partners of RP Technik have a clear advantage on the world markets, our unrelenting focus being on personal safety and building protection.



Profile systems		Curtain walls	Add-on curtain wall system	Doors	Partition walls	Windows	Sliding elements	EVIDENCE	
	RP-ISO-hermetic 45N	●							METALFORM National requirements, directives and building regulations specific to the various Federal States must be observed while taking into account evidence garnered from tests and any approvals related thereto.
	RP-ISO-hermetic 60N	●							
	RP-tec 55 (FERRO-WICTEC 55 E)	●							
	RP MULTITOP 50/60 Outlet	●							
	RP-tec 50-1 (FERRO-WICTEC 50-1 E)	●							
	RP-tec 55-1 (FERRO-WICTEC 55-1 E)	●							
	RP-tec 50-1 HA (FWT 50-1 HA E)	●							
	RP-tec 55-1 HA (FWT 55-1 HA E)	●							
	RP-tec 50-1 HA plus (FWT 50-1 HA E plus)	●							
	RP-tec 55-1 HA plus (FWT 55-1 HA E plus)	●							
	RP-tec 60-1 (FERRO-WICTEC 60-1 E)	●							
	RP-tec 60-1 HA (FWT 60-1 HA E)	●							
	RP-tec 80-1 (FERRO-WICTEC 80-1 E)	●							
	RP-tec 80-1 HA (FWT 80-1 HA E)	●							
	RP-ISO-hermetic 70 (FERRO-WICSTYLE 70)		●	●					
	RP-ISO-hermetic 70 (FERRO-WICLINE 70)				●				
	RP-ISO-hermetic 70 plus (FERRO-WICSTYLE 70 plus)			●	●				
	RP-ISO-hermetic 70 plus (FERRO-WICLINE 70 plus)					●			
	RP-hermetic FINELINE			●	●				
	RP-hermetic 40			●	●				
	RP-Design 50			●	●				
	RP-hermetic 50			●	●				
	RP-hermetic 55N (FERRO-WICSTYLE 55N)			●	●				
	RP-hermetic 55N (FERRO-WICLINE 55N)					●			
	RP-hermetic 55N FP (FERRO-WICSTYLE 55N FP)			●	●				
	RP-hermetic 75			●	●				
	RP-hermetic 75 FB			●	●				
	RP-ISO-hermetic EI30			●	●				
	RP-ISO-hermetic EI60			●	●				
	RP-ISO-hermetic EI90			●	●				
	RP-ISO-hermetic EI120			●	●				
	RP-ISO-hermetic 70 FP (FERRO-WICSTYLE 70 FP)			●	●				

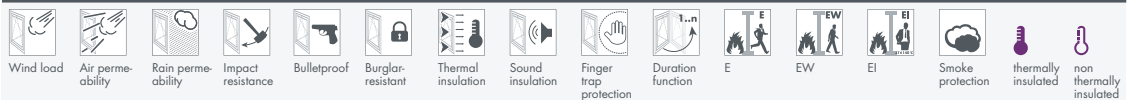

METALFORM

MASTERS OF METAL

UNITED KINGDOM

METALFORM

NORWAYMETAL LTD

53 Chelsea Manor Street

London, SW3 5RZ

SALES@METALFORM.UK

+44 20 81298814

GERMANY

METALFORM GMBH

Carl-Zeiss-Ring 15A

85737 Ismaning

SALES@METALFORMGROUP.DE

+49 17663630406

NORWAY

METALFORM AS

Brochmannsveien 2

1950 Rømskog

SALG@METALFORM.NO

+47 401 62 446

METALFORMGROUP

SALES@METALFORMGROUP.COM